

MORE 40



Schwern-Yachten

Jürgen Schwern (+49 171 4217434) & Frank Kuhlmann (+49 171 4170120)
www.schwern-yachten.de

| | |
|------------------|--|
| SHIPYARD | A-More Yachts Ltd Bana Josipa Jelačića 25B 21204 Dugopolje Croatia |
| DESIGNER | Cossutti Yacht Design |
| INTERIOR | Blue Emotion Yacht Engineering / Cossutti Yacht Design |
| ENGINEERING | Blue Emotion Yacht Engineering A-More Boats Ltd. Engineering Team |
| CE CERTIFICATION | DNV - Germanischer Lloyd (A Ocean) |

| | | |
|---------------------|----------------------------|----------------------|
| MEASUREMENTS | LENGHT OVERALL | 12,30 m |
| | LENGHT OF WATERLINE | 10,51 m |
| | HULL LENGHT | 11,99 m |
| | BEAM | 4,00 m |
| | DRAFT (std) | 1,98 m |
| | DISPLACEMENT | 7.400 kg |
| | BALLAST | 2.500 kg |
| | CABINS | 3 |
| | HEADS (std) | 1 |
| | ENGINE (STD) | Yanmar 30 hp SD |
| | FUEL (2 tanks) | 250 l |
| | WATER (2 tanks) | 2750 l |
| | MAIN SAIL | 53,00 m ² |
| GENOA (105%) | 42,00 m ² | |

CONSTRUCTION

Hull & Deck

Vacuum infused epoxy based vinylester cored GRP
 White (isophtalic) gelcoat with decorative bands
 Optimal strength/weight ratio - achieved by using multiaxial and unidirectional E-glass fibers
 Transparent gel coat under waterline for visual quality control
 Thermal and sound insulated hull and deck
 Stainless steel frame bellow saloon floor as reinforcement in way of keel, taking loads from keel stepped mast to
 Stress areas (where winches / major deck fittings are fixed) reinforced with alu or okoume plywood
 Hull and deck are bonded with structural glue and additionally laminated

Layout

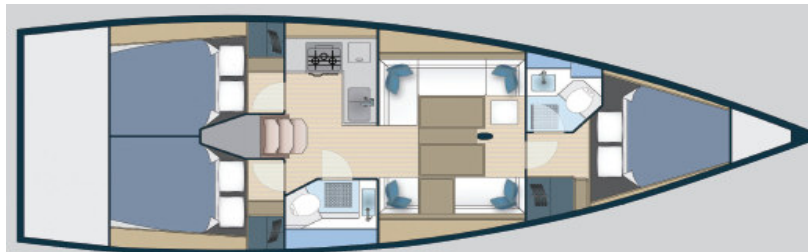

CHARTER VERSION LAYOUT

Charter version of More 40 has 3 cabins and 2 toilets with shower and is a great boat for charter holidays. Two toilets allow the crew to have intimacy on a 40 ft yacht.



OWNER'S VERSION LAYOUT

Owner's version of More 40 has 3 cabins and 1 toilet with shower plus skipper's table in the salon. Both versions of More 40 have the same equipment and are perfect for sailing and racing.

| | |
|-----------------------|--|
| DECK EQUIPMENT | <p>Teak on cockpit seats Stainless steel bow fitting (with anchor/chain roller) and attachment for asymmetrical spinnaker Stainless steel chainplates Self-draining anchor/chain locker 8 stainless steel stanchion bases 2 openable portlights in cockpit 8 hull windows 2 openable portlights on side coachroof 6 size 41 flush hatches 2 size 60 flush hatches</p> |
| Cockpit | <p>Storage locker in mid cockpit Dry stowage lockers on ps & sb side Outboard drained two gas bottles (ps) compartment Foldable helmsman footstops Rudder stock head for installing the emergency tiller Two steering pedestals Single lever engine control inside recess on cockpit side Swimming platform with swimming ladder manually operated</p> |
| RIGGING | <p>Mast Performance silver anodized aluminum mast fractional Triple swept back (approx. 20°) spreaders in aluminum, polyester sheets, main sail and jib halyard in vectran The mast step bolted to the stainless steel keel frame</p> <p>Boom Silver anodized aluminum boom Two (internal) reef lines for single line reefing system; one clew outhaul device The gas pressured boom vang with an outer purchase block system</p> <p>Standing rigging Discontinuous stainless steel dyform rigging (narrow) includes: Thru deck Jib Furler Hydraulic backstay adjuster/tensioner</p> <p>Running rigging All halyards, reef lines, tensioners and control lines are hidden bellow deck and led to the cockpit (winches) The standard mast includes: Main halyard, Spi halyard, Jib halyard, Boom topping lift</p> <p>Genoa and main sheet system SELDEN genoa sheet system 30 with track and travellers SELDEN main sheet system 30 Blocks</p> <p>Sheets & ropes: Main sheet Jib sheet 2 reefing lines Outhaul Full width main sheet traveler hidden bellow cockpit sole with possibility of easy transforming into mid boom sheeting system with possibility of big bimini covering whole cockpit</p> <p>Stoppers (Clutches) 10 x Spinlock 2 x 5 sheave deck organizers</p> |
| Winches | <p>2 Lewmar primaries/genoa sheet 2-speed winches, size 50 2 Lewmar secondary 2-speed winches size 45 2 Lewmar mainsheet 2-speed winches size 45 3 winch handles with PVC handle holders</p> |
| SHIP EQUIPMENT | <p>Steering system</p> |

MORE 40 STANDARD SPECIFICATIONS 2020/2021

| | |
|--|--|
| | <ul style="list-style-type: none"> Single rudder system Semi-balanced rudder with self aligning roller bearings Double Steering wheel black GFC 900mm Emergency tiller in stainless steel |
| Keel | <ul style="list-style-type: none"> Cast iron draft 1,98m Magnetic compass |
| Lights | Navigation lights (bow port, bow stbd, stern), running light, anchor light, deck light, all LED |
| Anchoring & Mooring Equipment | <ul style="list-style-type: none"> Stainless steel anchor arm Electric Anchor Windlass 6 x mooring cleats |
| INTERIOR: Furniture, Inventory | <ul style="list-style-type: none"> Standard interior layout (A): 3 cabins and 1 Head unit Large saloon with L shaped kitchen Interior Joinery: marine grade water proof core, faced with Alpi oak veneer All Bulkheads in okoume plywood Cushions are made in high quality foam with selected Verona upholstery Floorboards are Alucore- honeycomb 15 mm thick aluminum faced with ultrapas in wood colour |
| FORWARD CABIN | <ul style="list-style-type: none"> Lockers under Berth Wardrobes (port & stbd side) with Shelves and Hangers |
| FORWARD HEAD UNIT | <ul style="list-style-type: none"> GRP Wash Basins Corian wash basin Boards Hot&cold fresh water mixing taps also with shower unit Shower automatically drained by electric pump Manual marine Toilet Front opening double Locker - placed above wash basin - with mirrors mounted on fronts Waste holding tank (app. 55 l) fitted with external non contact sensors and tank level Watch, deck Outlet |
| AFT CABIN (STBD & PORT) | <ul style="list-style-type: none"> Double Berth with Shelve and Lockers above bed along Hull side Large hanging Locker and Shelve above Lockers under Berth |
| SALOON | <ul style="list-style-type: none"> Large U-shaped settee to Hull PS side with dining table I shaped settee to Hull STB side Upper Cabinet sections with doors along Hull sides Storage Lockers under seats and behind backrests |
| GALLEY | <ul style="list-style-type: none"> Galley with Corian work top Twin stainless steel rectangular sinks Mixing tap for pressurized hot&cold fresh water Gas stove (on gimbals) with an oven and three burners One refrigerator 100L Sea water foot pump Storage Lockers - with shelves and doors - above work top along Hull side Storage - with shelve and door - below sinks; Waste Basket mounted on Storage door |
| COMPANIONWAY | Gas springed openable stairs as Engine Compartment cover |
| ENGINE COMPARTMENT | <ul style="list-style-type: none"> Sound and thermal insulated with non flammable foam material Easy accessible through opening the Companionway stairs and/or removing the side hatches (provided in both aft cabins) Provided with Automatic Fire Extinguisher |
| SANITARY SYSTEMS; DISCHARGE SYSTEMS | <ul style="list-style-type: none"> Hot&cold pressurized fresh water system Ventilated fresh water tanks placed bellow berth in the forward cabin for a total capacity of app. 250l with inspection holes/covers |

Tank level gauge(s) (placed on electric switchboard)
 Mixing fresh water taps are fitted in both Head units and in the Galley
 Shower with hot&cold fresh water can be fitted in Cockpit
 Hot water tank capacity of 30 l heated by integrated heater run with 220V shore power or by engine cooling (fresh) water
 Shower basins are drained direct into the sea by electric shower pumps
 Electric shower pumps are operated by automatic switch
 Shower in cockpit (hot and cold water)

MACHINERY MAIN COMPONENTS

Yanmar engine 3JH3 30HP with sail drive
 Gear/gas lever control is placed in Cockpit
 Alternator 80A
 3 blade fixed propeller

SYSTEMS FOR MACHINERY MAIN

1 Fuel oil tank in stainless steel for a total capacity of app. 250 l
 Tank inspection hole/cover with incorporated fuel float
 Tank level gauge (placed on electric switchboard)
 Fuel oil Filter with water Separator

SHIP SYSTEMS

Bilge systems

Electric bilge pump, operated by automatic and/or manual switch
 Electric bilge pump for aft bilge operated by automatic and/or manual switch
 Hand operated bilge pump is positioned in the Cockpit

Electrical systems

24/12 V DC SYSTEM

Classic lights in whole interior
 Main Switchboard includes LED indicators and thermomagnetic switches
 12 V sockets
 Battery Charger
 100 Ah engine start Battery
 150 Ah service Batteries Bunk
 Battery Switch
 Safety battery protector Anode
 Emergency start crossover system

230 V AC POWER SUPPLY

230 V AC Distribution board
 Main Circuit Breaker
 230 V AC sockets
 Shore Power dock side Cable

| MORE 40 PRICE LIST 2020 - 2021 | | Price | |
|--------------------------------|---|--------------|--------------|
| Code | Price list validity: March, 2020. This price list automatically cancels all previously distributed. (E.&O.E.) | net. | inkl. 19% |
| BOAT | | | |
| VB001 | MORE 40 WITH STANDARD SPECIFICATION YANMAR 3YM, 30 HP with sail drive SD | € 197.500,00 | € 235.025,00 |
| VB002 | ENGINE YANMAR 3JH5 40HP with sail drive | € 2.500,00 | € 2.975,00 |
| KEEL | | | |
| VK001 | KEEL T-SHAPE, LEAD, DRAFT 2,3m | STANDARD | STANDARD |
| VK002 | RACING KEEL T-SHAPE, LEAD BULB, BODY IN STEEL FRAME COVERED WITH GRP BODY AND FILLED WITH EPOXY FOAM, DRAFT 2,3m (200 kg less than standard keel) | € 7.000,00 | € 8.330,00 |
| HULL | | | |
| VH001 | VACUUM INFUSED EPOXY BASED VINYLESTER HULL, WHITE ISOPHTHALIC GELCOAT | STANDARD | STANDARD |
| VH002 | COLOURED GELCOAT HULL PER RAL CARD | € 3.000,00 | € 3.570,00 |
| VH003 | PAINTED HULL (DOUBLE COAT) | € 8.000,00 | € 9.520,00 |
| INTERIOR LAYOUT | | | |
| ML001 | 3 CABINS / 1 HEAD VERSION (head in saloon) (1 fwd cabin / 2 aft cabins / chart table on stb side) | STANDARD | STANDARD |
| ML002 | 3 CABINS / 2 HEADS VERSION (1 head fwd cabin, 1 saloon) (1 forward cabin / 2 aft cabins / foldable chart table on stb side) | € 4.000,00 | € 4.760,00 |
| ML003 | 2 CABINS / 2 HEADS VERSION (1 forward cabin / 2 aft cabins / chart table on stb side) | ON REQUEST | ON REQUEST |
| PACKAGES | | | |
| VIP001 | READY TO SAIL PACKAGE GENOA CONTENDER REGATTA DACRON TRI RADIAL "One Sails MAIN SAIL CONTENDER REGATTA DACRON TRI RADIAL CUT FULL BATTEN LAZY BAG & LAZY JACK (spectra ropes) IN SUNBRELLA PLUS 3 BLADE FOLDING PROPELLER MOORING KIT (6 fenders, 4 mooring lines) ANCHORING KIT (Anchor Delta 16 Kg, chain 8 mm / 50 m) | € 11.100,00 | € 13.209,00 |
| VIP002 | ELECTRONIC PACKAGE B&G TRITON T41 INCL. SPEED, DEPTH, TEMP TRANSDUCER (1 SET) B&G TRITON DISPLAY T41 INCLUDING WIND TRANSDUCER (1 SET) B&G ZEUS TOUCH CHART PLOTTER ON HELM STATION VHF RADIO B&G V20 AUTOPILOT WITH L&S HYDRALIC LINEAR DRIVE FUSION radio MP3/ USB player FUSION cube speaker system in saloon, active subwoofer FUSION waterproof cockpit speakers | € 9.600,00 | € 11.424,00 |
| VIP003 | PREFORMANCE PACKAGE PREFORMANCE LEWAR WINCHES ST-EVO RACE PREFORMANCE GENOA AND MAIN SHEET SYSTEM ALL DYNEMA HALYARDS SPINNAKER DECK EQUIPMENT(SPI-POLE, SHEETS, BLOCKS,PADEYES) PREFORMANCE ALUMINUM MAST, DYFORM RIGGING | € 9.200,00 | € 10.948,00 |
| VIP004 | RACE PACKAGE HULL LIGHTER FOR 500kg (inner structure produced in vacuum lamination, only one toilette in front) JOHN MAST aluminium mast and boom, rod rigging W1 OUTER CHAIN PLATES, D1 INNER CHAIN PLATES RACING KEEL BACKSTAY RACING CASCADES (1:48) | € 35.000,00 | € 41.650,00 |
| VIP005 | CARBON RACE PACKAGE CARBON MAST, CARBON BOOM & CARBON SPINNAKER POLE CARBON RUDDER UPGRADED STEERING SYSTEM OUTER STAY RACING KEEL LAYOUT 3 CABINS 1 TOILETTE only 2 BLADE FOLDING PROPELLER REPEATER ON MAST 2 PCS | € 59.000,00 | € 70.210,00 |
| UPHOLSTERY | | | |
| VU001 | MATTRASSES & SALOON COUSHINS, Upholstery "Verona" | STANDARD | STANDARD |
| VU002 | MATTRASSES & SALOON COUSHINS, Upholstery "Aqua Clean" | € 900,00 | € 1.071,00 |
| VU003 | LEATHER UPHOLSTERY IN SALOON | € 1.500,00 | € 1.785,00 |
| VU004 | ECO LEATHER UPHOLSTERY IN SALOON | € 1.000,00 | € 1.190,00 |
| FURNITURE | | | |

| MORE 40 PRICE LIST 2020 - 2021 | | Price | |
|---|---|-------------|-------------|
| Code | Price list validity: March, 2020. This price list automatically cancels all previously distributed. (E.&O.E.) | net. | inkl. 19% |
| VF001 | FURNITURE VENEERED IN ALPI VENEER - OAK | STANDARD | STANDARD |
| VF002 | FURNITURE VENEERED IN ALPI VENEER - TEAK | € 5.000,00 | € 5.950,00 |
| VF003 | FURNITURE VENEERED IN NATURAL VENEER - TEAK | € 11.000,00 | € 13.090,00 |
| EXTRAS / ELEKTRONICS | | | |
| ÆEL001 | B&G TRITON DISPLAY T41 INCL. SPEED,DEPTH, TEMP TRANSDUCER (1 SET)-IN COCKPIT | € 1.280,00 | € 1.523,20 |
| ÆEL002 | B&G TRITON DISPLAY T41 INCLUDING WIND TRANSDUCER (1 SET)-IN COCKPIT | € 1.740,00 | € 2.070,60 |
| ÆEL003 | B&G ZEUS TOUCH T-7 CHART PLOTTER ON HELM STATION | € 1.850,00 | € 2.201,50 |
| ÆEL004 | NAIS-500 AIS CLASS B | € 1.250,00 | € 1.487,50 |
| ÆEL005 | VHF RADIO B&G V20 | € 510,00 | € 606,90 |
| ÆEL006 | VHF RADIO B&G V60 | € 940,00 | € 1.118,60 |
| ÆEL007 | H50 WIRELESS HEADPHONE FOR VHF RADIO V60 B&G | € 420,00 | € 499,80 |
| ÆEL008 | AUTOPILOT WITH L&S HYDRAULIC LINEAR DRIVE | € 5.490,00 | € 6.533,10 |
| ÆEL009 | AUTOPILOT REMOTE CONTROL | € 700,00 | € 833,00 |
| ÆEL010 | FUSION radio MP3/ USB player | € 490,00 | € 583,10 |
| ÆEL011 | FUSION cube speaker system in saloon with amplifier | € 490,00 | € 583,10 |
| ÆEL012 | FUSION waterproof cockpit speakers | € 290,00 | € 345,10 |
| DECK EQUIPMENT / SAILS & RIG | | | |
| VID001 | SELDEN PERFORMANCE ALUMINIUM MAST, STANDARD WIRE RIGGING | STANDARD | STANDARD |
| VID002 | JOHN MAST PERFORMANCE ALUMINIUM MAST WIRE RIGGING | € 8.000,00 | € 9.520,00 |
| VID003 | JOHN MAST ROD RIGGING | € 3.000,00 | € 3.570,00 |
| VID004 | PERFORMANCE LEWAR WINCHES ST-EVO RACE | € 2.360,00 | € 2.808,40 |
| VID005 | PERFORMANCE GENOA AND MAIN SHEET SYSTEM | € 2.360,00 | € 2.808,40 |
| VID006 | JIB 105% CONTENDER REGATTA DACRON TRI RADIAL CUT "One Sails" | € 2.920,00 | € 3.474,80 |
| VID007 | GENOA 135% CONTENDER REGATTA DACRON TRI RADIAL CUT"One Sails" | € 3.500,00 | € 4.165,00 |
| VID008 | MAIN SAIL CONTENDER REGATTA DACRON TRI RADIAL CUT FULL BATTEN "One Sails" | € 5.040,00 | € 5.997,60 |
| VID009 | JIB 105% SPECTRA HYDRA NET TRI RADIAL CUT | € 5.400,00 | € 6.426,00 |
| VID010 | GENOA 135% DP HYDRA NET TRI RADIAL CUT, Spectra, UV protection "One Sails" | € 6.500,00 | € 7.735,00 |
| VID011 | MAINSAIL DP HYDRA NET TRI RADIAL CUT, Spectra "One Sails" with MDS sliders | € 8.000,00 | € 9.520,00 |
| VID012 | GENNAKER "One Sails" | € 3.200,00 | € 3.808,00 |
| VID013 | SPINNAKER "One Sails" | € 3.200,00 | € 3.808,00 |
| VID014 | ALL DYNEMA HALYARDS | € 1.680,00 | € 1.999,20 |
| VID015 | GENNAKER DECK EQUIPMENT- SHEETS, BLOCKS, PADEYES | € 600,00 | € 714,00 |
| VID016 | SPINNAKER DECK EQUIPMENT- SPI POLE with car (aluminium), sheets, blocks, padeyes | € 1.680,00 | € 1.999,20 |
| VID017 | SPINNAKER POLE STORAGE VERTICAL ON MAST | € 650,00 | € 773,50 |
| VID018 | BIMINI TOP IN SUNBRELLA COVERING COCKPIT (possible to sail if main sheet moved to mid boom) | € 3.360,00 | € 3.998,40 |
| VID019 | SPRAYHOOD IN SUNBRELLA PLUS WITH STAINLESS STEEL TUBES | € 2.470,00 | € 2.939,30 |
| VID020 | LAZY BAG & LAZY JACK (spectra ropes) IN SUNBRELLA PLUS | € 960,00 | € 1.142,40 |
| VID021 | GRP VINYLESTHER EPOXY BASED FIXED BOW SPRIT WITH INTERGRATED ANCHOR ARM | € 2.800,00 | € 3.332,00 |
| VID022 | CARBON REGATTA BOW SPRIT | € 3.500,00 | € 4.165,00 |
| PROPULSION & ELECTRIC DECK EQUIPMENT | | | |
| VIP001 | BOWTHRUSTER ELECTRIC RETRACTABLE 6 Kw | € 6.400,00 | € 7.616,00 |
| VIP002 | 2 BLADE FOLDING PROPELLER | € 1.570,00 | € 1.868,30 |
| VIP003 | 3 BLADE FOLDING PROPELLER | € 1.900,00 | € 2.261,00 |
| VIP004 | ELECTRIC WINCH UPGRADE WITH ADDITIONAL BATTERY 140 Ah | € 3.000,00 | € 3.570,00 |
| VIP005 | INVERTER 12 220V 2000VA | € 2.960,00 | € 3.522,40 |
| EQUIPMENT | | | |
| VIDE01 | MOORING KIT (6 fenders, 4 mooring lines) | € 960,00 | € 1.142,40 |
| VIDE02 | ANCHORING KIT (anchor Delta 16 kg, chain 8mm/50m) | € 1.010,00 | € 1.201,90 |
| VIDE03 | 10MM NATURAL TEAK ON COCKPIT BENCHES | STANDARD | STANDARD |
| VIDE04 | 10MM NATURAL TEAK ON COCKPIT sole | € 4.480,00 | € 5.331,20 |
| VIDE05 | 10MM NATURAL TEAK ON SIDE DECK | € 10.000,00 | € 11.900,00 |
| VIDE06 | COUSHINS IN COCKPIT | € 800,00 | € 952,00 |
| VIDE07 | CARBON BATHING PLATFORM IN TEAK | € 2.240,00 | € 2.665,60 |
| VIDE08 | RACING CLEATS UPGRADE(6pcs) | € 2.000,00 | € 2.380,00 |

| MORE 40 PRICE LIST 2020 - 2021 | | Price | |
|--|--|--------------|------------------|
| Code | <i>Price list validity: March, 2020. This price list automatically cancels all previously distributed. (E.&O.E.)</i> | <i>net.</i> | inkl. 19% |
| VIDE09 | COCKPIT TABLE IN TEAK | € 1.570,00 | € 1.868,30 |
| VIDE10 | OUTBOARD ENGINE BRACKET | € 180,00 | € 214,20 |
| MI001 | ALUMINIUM FLOORS WITH LAMINATE TOP | STANDARD | STANDARD |
| MI002 | ALUMINIUM FLOORS WITH LUXURY VINIL TOP | € 1.500,00 | € 1.785,00 |
| MI003 | SERVICE BATTERY | STANDARD | STANDARD |
| MI004 | ENGINE BATTERY 100 Ah - AGM | STANDARD | STANDARD |
| MI005 | ADDITIONAL SERVICE BATTERY 100 Ah | € 260,00 | € 309,40 |
| MI006 | GEL UPGRADED BATTERIES (PCS) | € 1.000,00 | € 1.190,00 |
| MI007 | CHARGER 50 A | STANDARD | STANDARD |
| MI008 | WEBASTO HEATING AIRTOP 3900 W | € 4.500,00 | € 5.355,00 |
| MI009 | ADDITIONAL FRESH WATER TANK 120L | € 460,00 | € 547,40 |
| MI010 | OCEAN AIR BLINDS FOR ALL WINDOWS AND HATCHES | € 2.700,00 | € 3.213,00 |
| MI011 | ADDITIONAL FRIDGE 42L IN KITCHEN | € 1.850,00 | € 2.201,50 |
| MI012 | ELECTRIC TOILETTE, SEA WATER FLUSH (1 SET) (750 EUR per toilette) | € 750,00 | € 892,50 |
| TRANSPORT, LAUNCHING, COMMISSIONING | | | |
| VT001 | LAUNCHING & COMMISSIONING (includes transportation to shipyard marina, rigging, assembly of mast, keel and rail & crane) | € 10.500,00 | € 12.495,00 |
| VT002 | ANTIFOULING | € 3.000,00 | € 3.570,00 |
| VT003 | TRANSPORTATION CRADLE | € 2.520,00 | € 2.998,80 |
| VT004 | SEA FREIGHT PACKING | € 1.380,00 | € 1.642,20 |
| Delivery terms: EXW Dugopolje, HR (Incoterms 2000). Launching and commissioning operations will take place after delivery EXW Dugopolje | | | |